

Name: _____

Jacob bought 4 flags. Each flag cost 1 quarter and 7 pennies. How much did he spend in all?

Megan bought some seeds. She planted them in pots. They grew into corn plants. There were five plants. Each plant had four ears of corn on it. How many ears of corn were there in all?

Emma and Rose are making teddy bears. They will take the teddy bears to the Children's Hospital. Sick children will get the bears. So far they have made 12 bears. They use 4 buttons on each bear's shirt. How many buttons have they used in all?

Fill in the boxes so each line equals 15.

15		
90	÷	
	x	1
18	-	
(-)	+	15
	+	
	x	3

Color in $\frac{1}{2}$.

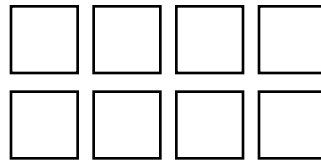

$$\begin{array}{r} 22 \\ + 97 \\ \hline \end{array}$$



$$\begin{array}{r} 12 \\ 46 \\ + 20 \\ \hline \end{array}$$

$$\begin{array}{r} 64 \\ + 58 \\ \hline \end{array}$$

Write a word to describe August.

$$17 + \boxed{} = 30$$

You ask Maria for the time. She says in fourteen minutes it will be seven. Write the time on your digital clock:

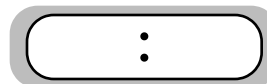

$$\begin{array}{r} 77 \\ - 47 \\ \hline \end{array}$$

Name: _____

955 962 939 975

Write the numbers in order from least to greatest.

least greatest

- morh
- morc
- march
- marh

$$\begin{array}{r} 91 \\ - 87 \\ \hline \end{array}$$

Write + or - in the circles.

8 ○ 7 ○ 17 = 2 ○ 16 ○ 0

7 ○ 1 ○ 6 = 3 ○ 3 ○ 12

$$2 \overline{)4}$$

$$2 \overline{)6}$$

3 x 1 = _____ 9 x 6 = _____

$$\begin{array}{r} 79 \\ + 94 \\ \hline \end{array}$$

21 + = 27

27 + = 31

79 + 60 = _____

Color in $\frac{3}{4}$ of the rectangle.



- wor
- woord
- word
- wurd

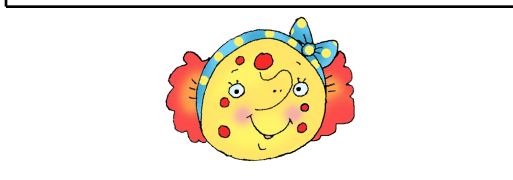

87 + 49 = _____

Circle the best estimate for the answer to:
108 + 64

210 170 260 270

$$\begin{array}{r} 41 \\ - 11 \\ \hline \end{array}$$

$$\begin{array}{r} 67 \\ - 42 \\ \hline \end{array}$$

$$\begin{array}{r} 30 \\ - 14 \\ \hline \end{array}$$

$$\begin{array}{r} 98 \\ - 48 \\ \hline \end{array}$$

$$\begin{array}{r} 39 \\ + 54 \\ \hline \end{array}$$

11 + = 25

6 + = 31

12 + = 27

28 + = 38

Name: _____

Draw 3 pictures in the correct order. Use each of the clues so you will know what to draw.

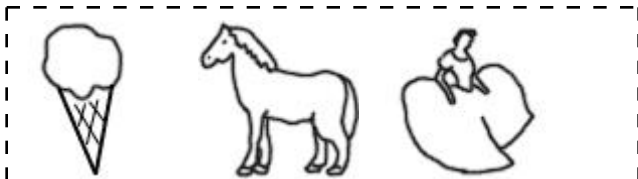

! Draw 1 of these 3 pictures.
! The picture is NOT in the correct spot.

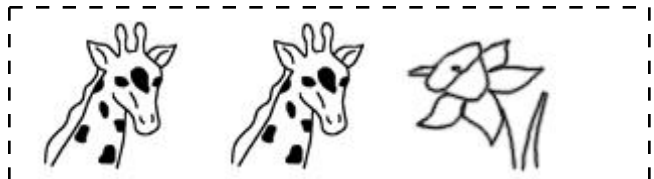

! Draw 1 of these 3 pictures.
! The picture IS in the correct spot.

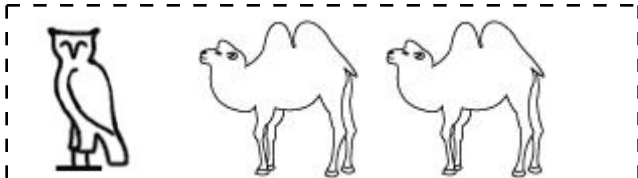

! Draw 1 of these 3 pictures.
! The picture IS in the correct spot.

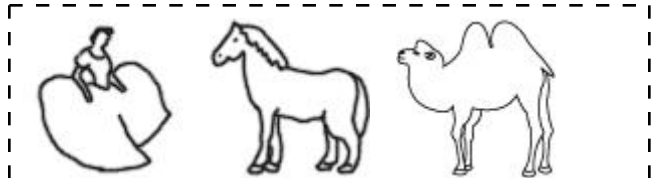

! Draw 2 of these 3 pictures.
! The pictures to use are in the correct spot.

Draw the 3 pictures in the correct order:

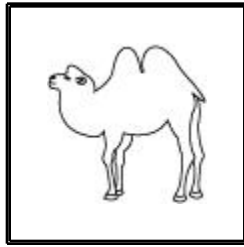
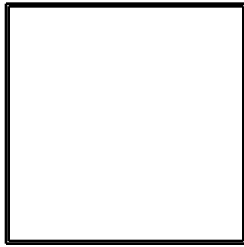
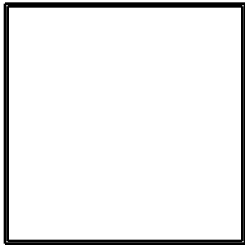

$$6 \overline{)36}$$

$$4 \overline{)20}$$

$$74 + 85 = \underline{\quad}$$



- fac
- fuyS
- face
- fece

$$\begin{array}{r} 6 \\ \times 1 \\ \hline \end{array}$$

$$\begin{array}{r} 9 \\ \times 4 \\ \hline \end{array}$$

$$77 - 32 = \underline{\quad}$$

- ruyd
- riad
- rayd
- raid

$$\begin{array}{r} 42 \\ + 85 \\ \hline \end{array}$$

$$\begin{array}{r} 61 \\ + 64 \\ \hline \end{array}$$

$$\begin{array}{r} 20 \\ + 59 \\ \hline \end{array}$$

$$\begin{array}{r} 36 \\ + 74 \\ \hline \end{array}$$

$$\begin{array}{r} 70 \\ + 50 \\ \hline \end{array}$$

$$\begin{array}{r} 57 \\ - 40 \\ \hline \end{array}$$

$$\begin{array}{r} 1 \\ \times 11 \\ \hline \end{array}$$

Name: _____

$$\begin{array}{r} 99 \\ - 20 \\ \hline \end{array}$$

$$\begin{array}{r} 49 \\ + 67 \\ \hline \end{array}$$

$$\begin{array}{r} 77 \\ + 58 \\ \hline \end{array}$$

$$\begin{array}{r} 80 \\ + 98 \\ \hline \end{array}$$

$$\begin{array}{r} 82 \\ - 61 \\ \hline \end{array}$$

$$\begin{array}{r} 100 \\ - 34 \\ \hline \end{array}$$

$$\begin{array}{r} 87 \\ + 51 \\ \hline \end{array}$$

$$\begin{array}{r} 94 \\ - 65 \\ \hline \end{array}$$

$$\begin{array}{r} 61 \\ - 34 \\ \hline \end{array}$$

$$\begin{array}{r} 140 \\ - 41 \\ \hline \end{array}$$

$$\begin{array}{r} 57 \\ + 91 \\ \hline \end{array}$$

$$\begin{array}{r} 40 \\ + 12 \\ \hline \end{array}$$

$$\begin{array}{r} 75 \\ - 64 \\ \hline \end{array}$$

$$\begin{array}{r} 89 \\ + 59 \\ \hline \end{array}$$

$$\begin{array}{r} 22 \\ + 70 \\ \hline \end{array}$$

$$\begin{array}{r} 116 \\ - 53 \\ \hline \end{array}$$

$$\begin{array}{r} 142 \\ - 96 \\ \hline \end{array}$$

$$\begin{array}{r} 32 \\ + 72 \\ \hline \end{array}$$

$$\begin{array}{r} 69 \\ + 84 \\ \hline \end{array}$$

$$\begin{array}{r} 40 \\ + 35 \\ \hline \end{array}$$

$$\begin{array}{r} 91 \\ - 16 \\ \hline \end{array}$$

$$\begin{array}{r} 36 \\ + 79 \\ \hline \end{array}$$

$$\begin{array}{r} 69 \\ - 45 \\ \hline \end{array}$$

$$\begin{array}{r} 121 \\ - 83 \\ \hline \end{array}$$

$$\begin{array}{r} 33 \\ + 84 \\ \hline \end{array}$$

$$\begin{array}{r} 125 \\ - 40 \\ \hline \end{array}$$

$$\begin{array}{r} 104 \\ - 93 \\ \hline \end{array}$$

$$\begin{array}{r} 57 \\ + 45 \\ \hline \end{array}$$

$$\begin{array}{r} 96 \\ + 38 \\ \hline \end{array}$$

$$\begin{array}{r} 94 \\ - 36 \\ \hline \end{array}$$

$$\begin{array}{r} 78 \\ + 47 \\ \hline \end{array}$$

$$\begin{array}{r} 174 \\ - 84 \\ \hline \end{array}$$

$$\begin{array}{r} 36 \\ + 13 \\ \hline \end{array}$$

$$\begin{array}{r} 126 \\ - 85 \\ \hline \end{array}$$

$$\begin{array}{r} 39 \\ + 74 \\ \hline \end{array}$$

$$\begin{array}{r} 168 \\ - 85 \\ \hline \end{array}$$

$$\begin{array}{r} 25 \\ + 57 \\ \hline \end{array}$$

$$\begin{array}{r} 124 \\ - 78 \\ \hline \end{array}$$

$$\begin{array}{r} 43 \\ + 63 \\ \hline \end{array}$$

$$\begin{array}{r} 116 \\ - 77 \\ \hline \end{array}$$

$$\begin{array}{r} 99 \\ + 38 \\ \hline \end{array}$$

$$\begin{array}{r} 188 \\ - 98 \\ \hline \end{array}$$

$$\begin{array}{r} 7 \\ + 3 \\ \hline \square \\ + 2 \\ \hline \square \\ + 9 \\ \hline 21 \\ - \square \\ \hline 19 \\ + 2 \\ \hline \square \\ + 2 \\ \hline \square \\ - \square \\ \hline 16 \\ + \square \\ \hline 19 \\ + \square \\ \hline 23 \\ - 2 \\ \hline \square \end{array}$$

Name: _____

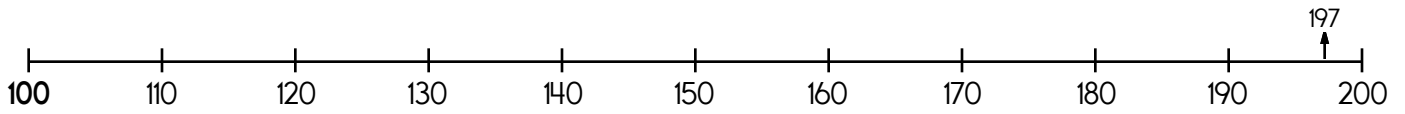

197 rounded to the nearest hundreds place is _____

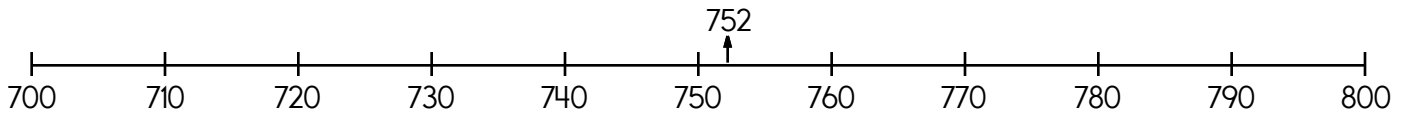

752 rounded to the nearest hundreds place is _____

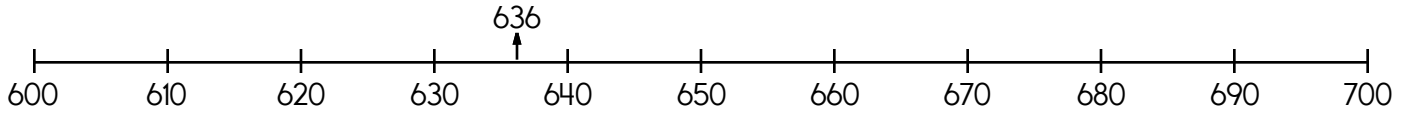

636 rounded to the nearest hundreds place is _____

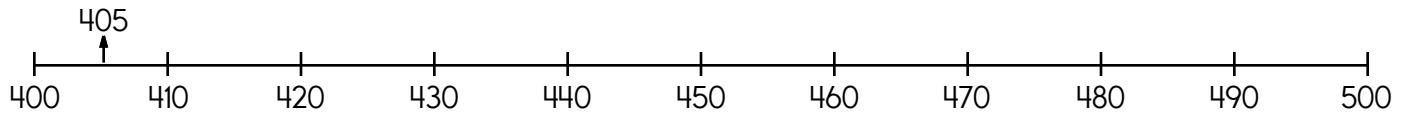

405 rounded to the nearest hundreds place is _____

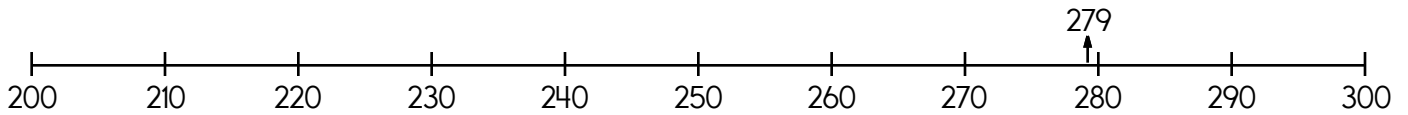

279 rounded to the nearest hundreds place is _____

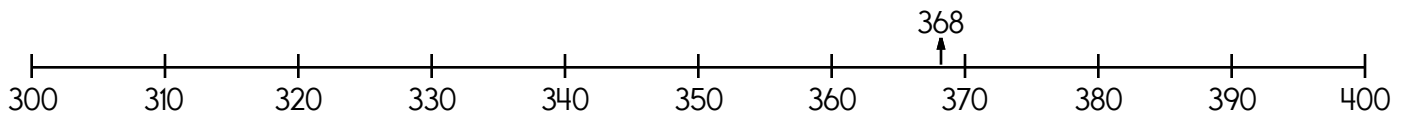

368 rounded to the nearest hundreds place is _____

Name: _____

Is 9943 closer to 9890 or 9990?

$$\begin{array}{r} 9943 \\ - 9890 \\ \hline \end{array} \qquad \begin{array}{r} 9990 \\ - 9943 \\ \hline \end{array}$$

9943 is _____ away from 9890.

9943 is _____ away from 9990.

9943 is closest to _____.

Is 347 closer to 300 or 400?

$$\begin{array}{r} 347 \\ - 300 \\ \hline \end{array} \qquad \begin{array}{r} 400 \\ - 347 \\ \hline \end{array}$$

347 is _____ away from 300.

347 is _____ away from 400.

347 is closest to _____.

Is 763 closer to 700 or 800?

$$\begin{array}{r} 763 \\ - 700 \\ \hline \end{array} \qquad \begin{array}{r} 800 \\ - 763 \\ \hline \end{array}$$

763 is _____ away from 700.

763 is _____ away from 800.

763 is closest to _____.

Is 7998 closer to 7310 or 8310?

$$\begin{array}{r} 7998 \\ - 7310 \\ \hline \end{array} \qquad \begin{array}{r} 8310 \\ - 7998 \\ \hline \end{array}$$

7998 is _____ away from 7310.

7998 is _____ away from 8310.

7998 is closest to _____.

Is 980 closer to 900 or 1000?

$$\begin{array}{r} 980 \\ - 900 \\ \hline \end{array} \qquad \begin{array}{r} 1000 \\ - 980 \\ \hline \end{array}$$

980 is _____ away from 900.

980 is _____ away from 1000.

980 is closest to _____.

Is 1581 closer to 1520 or 1620?

$$\begin{array}{r} 1581 \\ - 1520 \\ \hline \end{array} \qquad \begin{array}{r} 1620 \\ - 1581 \\ \hline \end{array}$$

1581 is _____ away from 1520.

1581 is _____ away from 1620.

1581 is closest to _____.

Name: _____

Round each number to the nearest hundreds. Add or subtract to get an estimate of the answer.

$$\begin{array}{r} 948 \longrightarrow \boxed{900} \\ - 513 \longrightarrow \boxed{500} \\ \hline 1500 \end{array}$$

$$\begin{array}{r} 181 \longrightarrow \boxed{} \\ + 402 \longrightarrow \boxed{} \\ \hline \end{array}$$

$$\begin{array}{r} 668 \longrightarrow \boxed{} \\ - 525 \longrightarrow \boxed{} \\ \hline \end{array}$$

$$\begin{array}{r} 133 \longrightarrow \boxed{} \\ + 327 \longrightarrow \boxed{} \\ \hline \end{array}$$

$$\begin{array}{r} 711 \longrightarrow \boxed{} \\ + 722 \longrightarrow \boxed{} \\ \hline \end{array}$$

$$\begin{array}{r} 796 \longrightarrow \boxed{} \\ - 457 \longrightarrow \boxed{} \\ \hline \end{array}$$

$$\begin{array}{r} 864 \longrightarrow \boxed{} \\ - 527 \longrightarrow \boxed{} \\ \hline \end{array}$$

$$\begin{array}{r} 848 \longrightarrow \boxed{} \\ + 867 \longrightarrow \boxed{} \\ \hline \end{array}$$

$$\begin{array}{r} 531 \longrightarrow \boxed{} \\ + 371 \longrightarrow \boxed{} \\ \hline \end{array}$$

$$\begin{array}{r} 575 \longrightarrow \boxed{} \\ + 481 \longrightarrow \boxed{} \\ \hline \end{array}$$

$$\begin{array}{r} 433 \longrightarrow \boxed{} \\ - 159 \longrightarrow \boxed{} \\ \hline \end{array}$$

$$\begin{array}{r} 624 \longrightarrow \boxed{} \\ - 619 \longrightarrow \boxed{} \\ \hline \end{array}$$

Name: _____

Round to the nearest ten.

$$\begin{array}{r} 44 \rightarrow \quad \boxed{40} \\ + 24 \rightarrow \quad \boxed{20} \\ \hline \end{array}$$

$$\begin{array}{r} 6 \rightarrow \quad \boxed{} \\ + 31 \rightarrow \quad \boxed{} \\ \hline \end{array}$$

$$\begin{array}{r} 86 \rightarrow \quad \boxed{} \\ - 35 \rightarrow \quad \boxed{} \\ \hline \end{array}$$

Round to the nearest hundred.

$$\begin{array}{r} 830 \rightarrow \quad \boxed{800} \\ + 795 \rightarrow \quad \boxed{800} \\ \hline \end{array}$$

$$\begin{array}{r} 955 \rightarrow \quad \boxed{} \\ - 531 \rightarrow \quad \boxed{} \\ \hline \end{array}$$

$$\begin{array}{r} 687 \rightarrow \quad \boxed{} \\ - 108 \rightarrow \quad \boxed{} \\ \hline \end{array}$$

Round to the nearest hundred.

$$\begin{array}{r} 168 \rightarrow \quad \boxed{200} \\ + 655 \rightarrow \quad \boxed{700} \\ \hline \end{array}$$

$$\begin{array}{r} 313 \rightarrow \quad \boxed{} \\ + 944 \rightarrow \quad \boxed{} \\ \hline \end{array}$$

$$\begin{array}{r} 847 \rightarrow \quad \boxed{} \\ + 467 \rightarrow \quad \boxed{} \\ \hline \end{array}$$

Round to the nearest ten.

$$\begin{array}{r} 88 \rightarrow \quad \boxed{90} \\ - 42 \rightarrow \quad \boxed{40} \\ \hline \end{array}$$

$$\begin{array}{r} 79 \rightarrow \quad \boxed{} \\ + 99 \rightarrow \quad \boxed{} \\ \hline \end{array}$$

$$\begin{array}{r} 16 \rightarrow \quad \boxed{} \\ + 74 \rightarrow \quad \boxed{} \\ \hline \end{array}$$

Name: _____

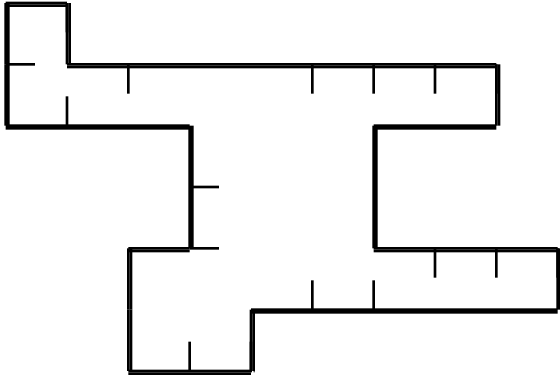

Perimeter =

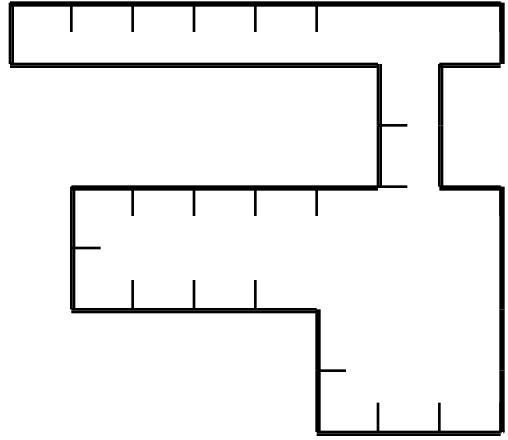

Perimeter =

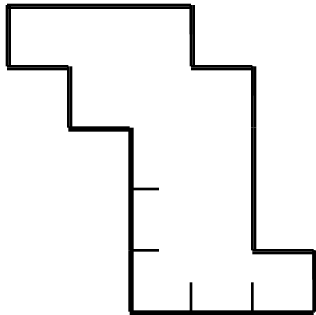

Perimeter =

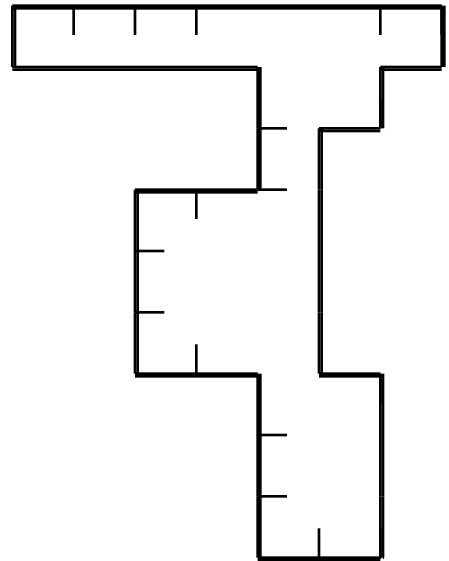

Perimeter =

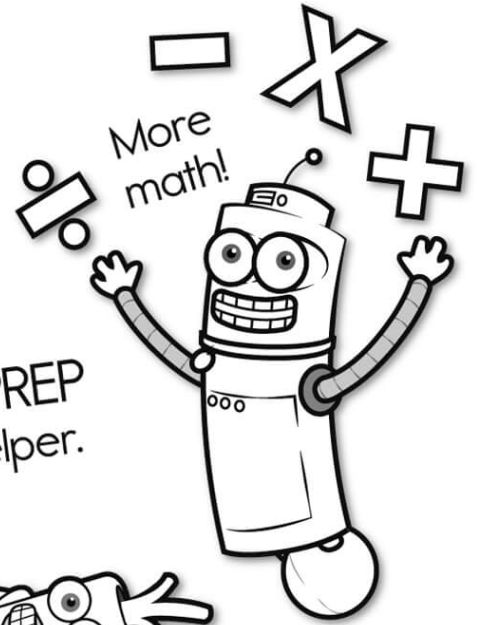
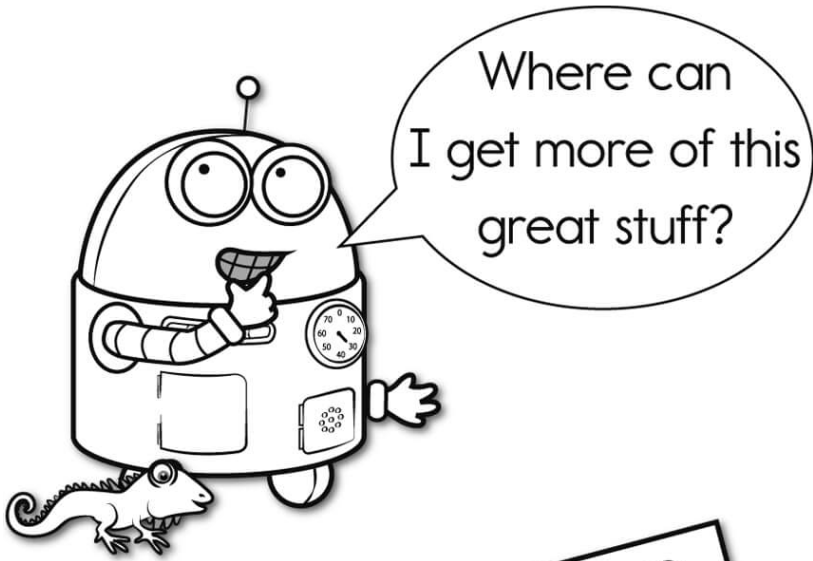

It's NO PREP at edHelper.

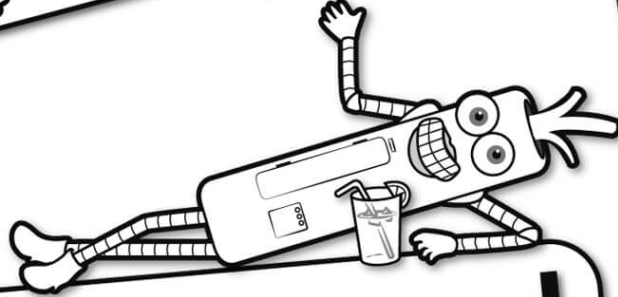

edHelper.com!

More history!

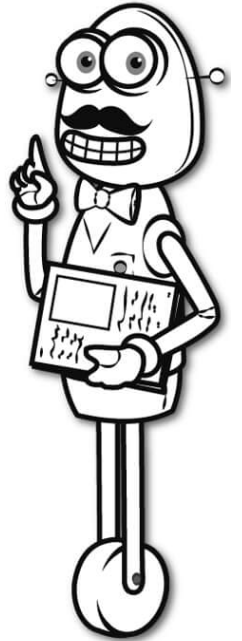

only \$19.99 per year

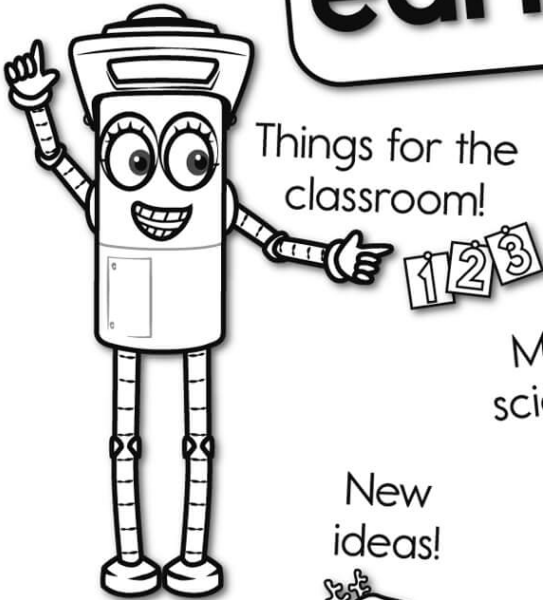

Things for the classroom!



New ideas!



More science!



More puzzles!

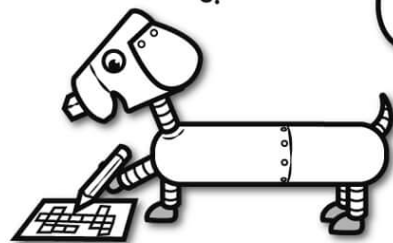

Take The Boring Out Of Homework!

Easy to
print!

edHelper

Weekly K-6 "Take It Home" Books

Kids want choices
for homework.
"Take It Home" books
have fun graphics and
challenging puzzles and
problems for older kids.

"Dr. Programmer"
challenges kids..

Homework
will never be
the same!

edHelper.com

