



Name: _____

<p>Justin learned a new magic trick. He learned how to make a quarter disappear. If Justin has \$4 worth of quarters and makes five of them disappear, how much money will he have left?</p>	<p>The moon's diameter (distance across) is 3,476 kilometers. Write the diameter of the moon in expanded form.</p>	<p>"Little Boy Blue, come blow your horn. The sheep is in the meadow; the cow is in the corn....." The farmer sold some corn for 25¢ per ear. Mr. Brown bought 7 ears. How much did the corn cost?</p>
--	--	--

Draw 3 pictures in the correct order. Use each of the clues so you will know what to draw.

	
<p>Draw 1 of these 3 pictures. The picture IS in the correct spot.</p>	<p>Draw 1 of these 3 pictures. The picture IS in the correct spot.</p>
	
<p>Draw 1 of these 3 pictures. The picture is NOT in the correct spot.</p>	<p>Draw 2 of these 3 pictures. The pictures to use are in the correct spot.</p>

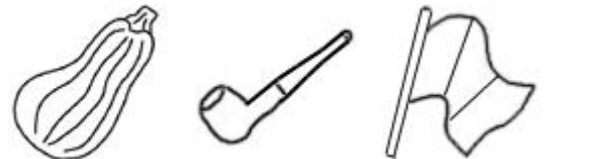
Draw the 3 pictures in the correct order:

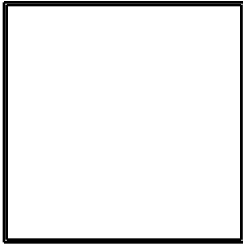
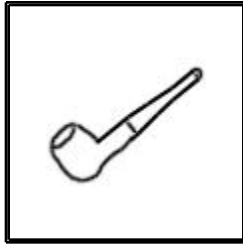
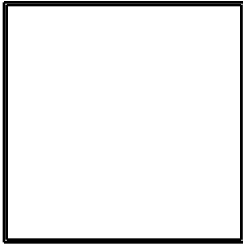
		
---	---	---

$9 \times 2 = \underline{\hspace{2cm}}$

$5 \times 8 = \underline{\hspace{2cm}}$



Name: _____

Add. Fill in the blanks.

+	1	9
9	10	
7	8	16
4		

+	9	
6		9
6	15	
1	10	

$$\begin{array}{r} 9 \\ 7 \\ + 19 \\ \hline \end{array}$$

Fill in the blanks with these numbers:
7, 1, 1

	0	2
2	7	4
+	4	
7	8	

Fill in the blanks with these numbers:
7, 2, 4

	3	0
2	9	1
+		
9	4	8

$$\begin{array}{r} 3 \\ \times 11 \\ \hline \end{array}$$

Expand the number.

6,933 = _____ + _____ + _____ + _____

$$\begin{array}{r} 97 \\ + 79 \\ \hline \end{array}$$

$$2 \overline{)14}$$

21 + = 25

25 + = 33

Write a word to describe May.

Count by 6s.

5 + = 36

72

120

Name: _____

Sudoku Sums of 6

Each row, column, and box must have the numbers 1 through 9.
All nine numbers must be used, and none can be repeated.
Hint: Look for sudoku sums. The sum of the two boxes inside of the dashed lines is 6.

Here is an example of a sudoku sum of 6:



$$\begin{array}{r} 96 \\ - 43 \\ \hline \end{array}$$

5			1		7			
		3	2				5	
		7			8			6
			4					5
		5			2			
	6	4			5	3	8	9
9							5	
					9	2	4	
	8						7	9

$93 - 75 = \underline{\hspace{2cm}}$

$26 - 16 = \underline{\hspace{2cm}}$

benc

bech

bench

benh

$7 \overline{)49}$

$2 \overline{)16}$

Name: _____

$$\begin{array}{r} 10,444 \\ - 1,564 \\ \hline \end{array}$$

$$\begin{array}{r} 4,330 \\ - 1,614 \\ \hline \end{array}$$

$$\begin{array}{r} 4,488 \\ + 7,438 \\ \hline \end{array}$$

$$\begin{array}{r} 2,878 \\ + 7,048 \\ \hline \end{array}$$

$$\begin{array}{r} 4,438 \\ + 8,250 \\ \hline \end{array}$$

$$\begin{array}{r} 15,543 \\ - 9,121 \\ \hline \end{array}$$

$$\begin{array}{r} 7,836 \\ - 5,163 \\ \hline \end{array}$$

$$\begin{array}{r} 9,046 \\ - 5,953 \\ \hline \end{array}$$

$$\begin{array}{r} 6,051 \\ + 1,883 \\ \hline \end{array}$$

$$\begin{array}{r} 5,577 \\ - 2,888 \\ \hline \end{array}$$

$$\begin{array}{r} 4,893 \\ + 8,608 \\ \hline \end{array}$$

$$\begin{array}{r} 3,267 \\ + 1,771 \\ \hline \end{array}$$

$$\begin{array}{r} 3,465 \\ + 7,104 \\ \hline \end{array}$$

$$\begin{array}{r} 11,033 \\ - 5,156 \\ \hline \end{array}$$

$$\begin{array}{r} 11,360 \\ - 1,903 \\ \hline \end{array}$$

$$\begin{array}{r} 12,790 \\ - 7,758 \\ \hline \end{array}$$

$$\begin{array}{r} 7,062 \\ + 7,344 \\ \hline \end{array}$$

$$\begin{array}{r} 7,207 \\ + 5,958 \\ \hline \end{array}$$

$$\begin{array}{r} 10,439 \\ - 8,533 \\ \hline \end{array}$$

$$\begin{array}{r} 6,325 \\ + 7,413 \\ \hline \end{array}$$

$$\begin{array}{r} 7,543 \\ - 3,493 \\ \hline \end{array}$$

$$\begin{array}{r} 6,706 \\ - 2,479 \\ \hline \end{array}$$

$$\begin{array}{r} 3,619 \\ + 1,718 \\ \hline \end{array}$$

$$\begin{array}{r} 1,732 \\ + 5,776 \\ \hline \end{array}$$

$$\begin{array}{r} 12,158 \\ - 3,856 \\ \hline \end{array}$$

$$\begin{array}{r} 10,165 \\ - 2,222 \\ \hline \end{array}$$

$$\begin{array}{r} 1,603 \\ + 6,865 \\ \hline \end{array}$$

$$\begin{array}{r} 11,018 \\ - 5,469 \\ \hline \end{array}$$

$$\begin{array}{r} 4 \\ + 2 \\ \hline \square \\ + 2 \\ \hline \square \\ + 8 \\ \hline \square \\ + 9 \\ \hline 25 \\ - \square \\ \hline 22 \\ - 5 \\ \hline \square \\ + 5 \\ \hline 22 \\ + \square \\ \hline 27 \\ + \square \\ \hline 36 \\ + \square \\ \hline 41 \\ + 6 \\ \hline \square \end{array}$$

Name: _____

372
733
377
371

_____ > _____ > _____ > 371

884
341
216
655

_____ > _____ > _____ > _____

778
817
987
659

_____ < _____ < _____ < _____

323
523
723
823

_____ < _____ < _____ < _____

$$\begin{array}{r} 529 \\ + 93 \\ \hline \end{array}$$

$$\begin{array}{r} 876 \\ - 65 \\ \hline \end{array}$$

$$\begin{array}{r} 868 \\ - 89 \\ \hline \end{array}$$

$$\begin{array}{r} 815 \\ + 76 \\ \hline \end{array}$$

$$\begin{array}{r} 807 \\ + 67 \\ \hline \end{array}$$

$\begin{array}{r} 74 \\ - 50 \\ \hline \end{array}$	$\begin{array}{r} 27 \\ - 11 \\ \hline \end{array}$	$\begin{array}{r} 33 \\ - 18 \\ \hline \end{array}$	$\begin{array}{r} 41 \\ - 35 \\ \hline \end{array}$	$\begin{array}{r} 87 \\ + 78 \\ \hline \end{array}$	$\begin{array}{r} 80 \\ - 36 \\ \hline \end{array}$
$\begin{array}{r} 40 \\ + 82 \\ \hline \end{array}$	$\begin{array}{r} 31 \\ + 21 \\ \hline \end{array}$	$\begin{array}{r} 36 \\ + 89 \\ \hline \end{array}$	$\begin{array}{r} 34 \\ + 29 \\ \hline \end{array}$	$5 \overline{)40}$	



Name: _____

$\frac{1}{2}$						$\frac{1}{2}$					
$\frac{1}{3}$				$\frac{1}{3}$				$\frac{1}{3}$			
$\frac{1}{4}$			$\frac{1}{4}$			$\frac{1}{4}$			$\frac{1}{4}$		
$\frac{1}{5}$		$\frac{1}{5}$		$\frac{1}{5}$		$\frac{1}{5}$		$\frac{1}{5}$		$\frac{1}{5}$	
$\frac{1}{8}$	$\frac{1}{8}$	$\frac{1}{8}$	$\frac{1}{8}$	$\frac{1}{8}$	$\frac{1}{8}$	$\frac{1}{8}$	$\frac{1}{8}$	$\frac{1}{8}$	$\frac{1}{8}$	$\frac{1}{8}$	$\frac{1}{8}$
$\frac{1}{10}$	$\frac{1}{10}$	$\frac{1}{10}$	$\frac{1}{10}$	$\frac{1}{10}$	$\frac{1}{10}$	$\frac{1}{10}$	$\frac{1}{10}$	$\frac{1}{10}$	$\frac{1}{10}$	$\frac{1}{10}$	$\frac{1}{10}$
$\frac{1}{12}$	$\frac{1}{12}$	$\frac{1}{12}$	$\frac{1}{12}$	$\frac{1}{12}$	$\frac{1}{12}$	$\frac{1}{12}$	$\frac{1}{12}$	$\frac{1}{12}$	$\frac{1}{12}$	$\frac{1}{12}$	$\frac{1}{12}$

Compare.

$\frac{4}{8} = \frac{1}{2}$	$\frac{8}{10} > \frac{6}{12}$	$\frac{1}{2} \circ \frac{1}{8}$	$\frac{7}{8} \circ \frac{4}{5}$
$\frac{2}{5} \circ \frac{4}{10}$	$\frac{2}{3} < \frac{4}{5}$	$\frac{1}{3} \circ \frac{1}{4}$	$\frac{1}{2} \circ \frac{1}{4}$
$\frac{2}{12} \circ \frac{3}{10}$	$\frac{6}{8} \circ \frac{9}{12}$	$\frac{7}{8} \circ \frac{3}{4}$	$\frac{1}{5} \circ \frac{2}{12}$
$\frac{6}{10} \circ \frac{2}{3}$	$\frac{3}{8} \circ \frac{4}{12}$	$\frac{9}{12} \circ \frac{3}{4}$	$\frac{2}{3} \circ \frac{1}{10}$
$\frac{3}{5} \circ \frac{1}{2}$	$\frac{4}{8} \circ \frac{2}{12}$	$\frac{1}{3} \circ \frac{1}{2}$	$\frac{2}{4} \circ \frac{5}{10}$
$\frac{3}{5} \circ \frac{3}{4}$	$\frac{4}{5} \circ \frac{9}{12}$	$\frac{2}{4} \circ \frac{1}{2}$	$\frac{2}{3} \circ \frac{4}{8}$

Name: _____

Complete each analogy with the best word.

- | | | |
|--------|------------|---------|
| anchor | water | leaf |
| root | black | wind |
| rowing | vegetable | eat |
| camel | whale | fruit |
| dinner | polar bear | white |
| sun | snack | striped |
| lunch | cold | |

rainforest : monkey ::

desert : _____

grizzly bear : brown ::

polar bear : _____

car : gasoline ::

sailboat : _____

acorn : nut ::

apple : _____

Fill in the numbers.

36	
46	

	45

	73

12	

	74

	93

28	

	69

	85

	66

$7 + \square = 18$

$13 + \square = 28$

$7 + \square = 25$

$23 + \square = 29$



It's NO PREP at edHelper.



edHelper.com!

More history!



only \$19.99 per year



Things for the classroom!

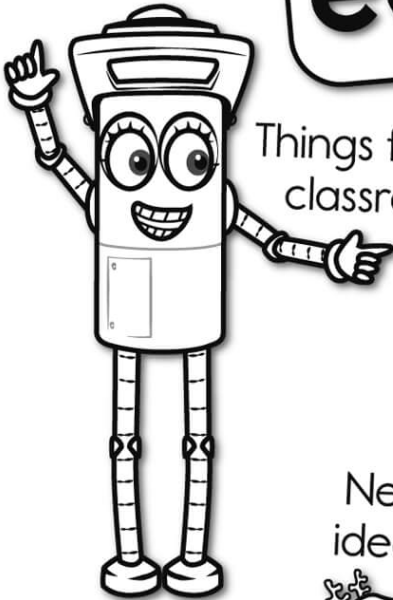

More science!



New ideas!



More puzzles!

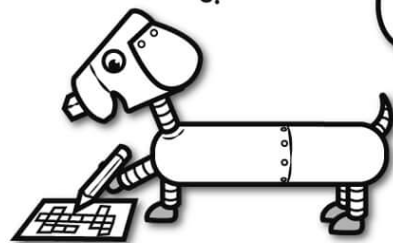

Take The Boring Out Of Homework!

Easy to
print!

edHelper

Weekly K-6 "Take It Home" Books

Kids want choices
for homework.
"Take It Home" books
have fun graphics and
challenging puzzles and
problems for older kids.

"Dr. Programmer"
challenges kids..

Homework
will never be
the same!

edHelper.com

